

# SPRINT

Colour thermal card printer with built-in RFID module



Sprint is a colour thermal card printer specifically conceived to ensure total reliability, versatility and speed, which are essential features to guarantee the efficiency of any ticketing system.

The Sprint printer allows to issue traditional 1D or 2D barcode tickets and – thanks to the built-in RFID module – contactless cards compliant to ISO standards. ISO 15693 and 14443A/B cards can be printed, coded, and read for checking; it is also possible to repeatedly write and erase thermal-rewritable surface tickets.

Thanks to the integrated loading system, the Sprint printer ensures continuous operation: the tickets to be printed can be automatically collected from the loading system or inserted manually through the front slot, one at a time, for reading and reloading operations.

## MAIN FEATURES

- Grayscale printing
- Printing quality: 300 dpi
- High issuing speed
- Compatible with any ISO 7810 medium
- Integrated loading system holding up to 250 cards (0.76 mm)
- Card thickness adjustment (0.2 – 1.0 mm)
- ISO 15693 and 14443A/B tag reading/writing
- Standard 1D and 2D barcodes
- Drivers for Windows XP, Vista and 7 (32 and 64 bit) available

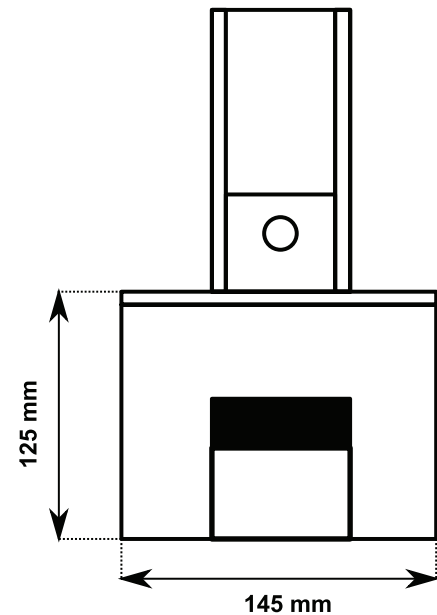
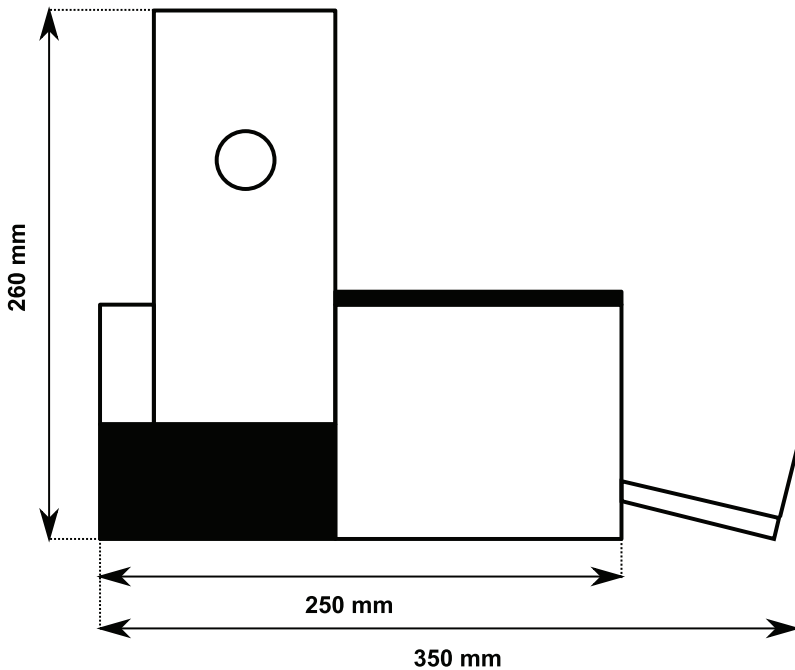

## Technical characteristics

Size:	145 x 260 x 350 mm
Weight:	approximately 6 kg
Power supply:	100-240 V AC 50-60 Hz
Interfaces:	USB

